

Through Hole High Current Inductors - RCB1618P SERIES



PART NUMBERING SYSTEM

RCB	1618P	—	501K	—	LF
TYPE	DIMENSIONS		INDUCTANCE		LEAD FREE

U : UL sleeve
P : PET sleeve

SHAPES AND DIMENSIONS

UNIT : mm

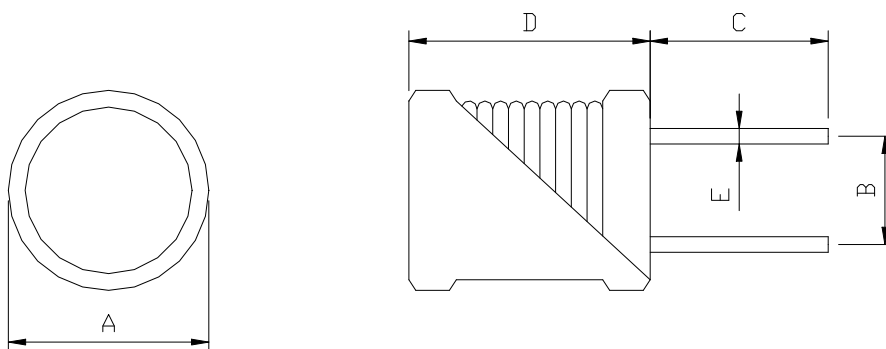

A= 18.0 Max. , B= 10.0±0.5 , C= 15.0±5.0 , D= 20.0 Max. , E= 1.0 Ref.

STRUCTURAL DIAGRAM :

COMPONENT	MATERIALS
1.Core	Ferrite core
2.Wire	Polyurethane enameled copper wires
3.Lead wire	Tinned copper wires
4.Tube	Heat shrinkable tube, PET or UL
5.Glue	Epoxy resin



Through Hole High Current Inductors - RCB1618P SERIES



SPECIFICATION TABLE

PART NUMBER	INDUCTANCE (μ H)	DCR ($m\Omega$) (max)	IDC (A) (max)	TEST FREQ. (Freq.)
RCB1618-100M-LF	10	9	8.0	1KHz
RCB1618-250K-LF	25	22	6.0	1KHz
RCB1618-500K-LF	50	36	4.0	1KHz
RCB1618-101K-LF	100	90	3.0	1KHz
RCB1618-251K-LF	250	150	2.0	1KHz
RCB1618-501K-LF	500	300	1.2	1KHz
RCB1618-102K-LF	1000	600	1.0	1KHz

1. Inductors Tolerance : K = +/-10% ; M=+/-20%
2. Operating temperature range -40°C to +85°C
3. Electronical specifications at 25°C